

Certification Process: Book 20 Zhaga-D4i Modules

Organisation



Associate or regular membership of the DALI Alliance is required.

[How to join.](#)



Associate or regular membership of Zhaga is required. [Joining Zhaga.](#)



Process

- 1 Product self-tested or tested by a DALI test center
- 2 Submit results to the DALI Alliance for verification and D4i certification
- 3 Submit product documentation to Zhaga test center
- 4 Tested for compliance against Zhaga specifications
- 5 Product awarded Zhaga-D4i certification and use of Zhaga and D4i logos

Comment

Zhaga-D4i certification starts with D4i certification and is based on IEC 62386 parts 101 and 103, and DALI Alliance Part 351. For a device to be compliant and qualify for combined Zhaga-D4i certification, it must be a Part 351 Type C or a bus-powered Type D device only.

Only one LEX-M is permitted for indoor lighting applications defined in Book 20. Type C devices are always bus powered and are designed to take control of the ECG. Type D single-master application controllers are permitted if powered only by the DALI bus.

Once D4i certification is achieved, a product can be submitted to a Zhaga test center for Zhaga Book 20 testing. This is typically a paperwork exercise to confirm the products meet the requirement of Book 20.

Either a Type C or a bus-powered Type D control device can be plugged into a Book 20 compliant luminaire.

Zhaga-D4i certification requires that a product is tested and certified to both Zhaga Book 20 and is D4i certified by the DALI Alliance.

A List of Zhaga approved test centers can be found [here](#). Only specific test centers can certify for specific books. Test centers can offer advice and direction with product approval, and some can also offer DALI and D4i testing.

Certification Process: Book 20 Zhaga-D4i Luminaires

Organisation



Process

- 1 Compile required documentation and submit to Zhaga test center
- 2 Tested for compliance against Zhaga specifications
- 3 Product awarded Zhaga-D4i certification and use of Zhaga and D4i logos

Comment

A compliant luminaire will include at least one D4i certified driver, a Book 20 defined mounting interface, and shall have one and only one Zhaga Book 20 compliant Luminaire Plug (LEX-LP).

An intra luminaire DALI bus will provide connection to the LEX-LP interface. Certification is typically a paperwork exercise to confirm the products meet the requirement of the book.

To certify a luminaire only Zhaga Consortium membership is required.



Associate or regular membership of Zhaga is required. [Joining Zhaga.](#)

A List of Zhaga approved test centers can be found [here](#). Only specific test centers can certify for specific books. Test centers can offer advice and direction with product approval, and some can also offer DALI and D4i testing.

Certification Process: Zhaga Book 20 Components

Organisation



Associate or regular membership of Zhaga is required. [Joining Zhaga.](#)

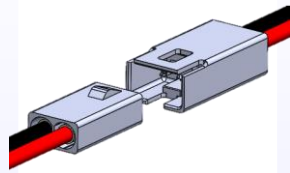

Process

- 1 Compile required documentation and sample and submit to Zhaga Test Centre
- 2 Tested for compliance against Zhaga specifications
- 3 Product awarded Zhaga certification and use of Zhaga logos

Comment

Both documentation, including a measurement report, and samples of the product are required to be submitted to an approved test centre. A compliant component will meet all the requirements of Book 20.

The test centre will confirm that the submitted measurement report meets the specified dimensional and tolerance requirements of Book 20. The test centre will also conduct physical testing of specified dimensions and features designated in Book 20.

To certify a component only Zhaga Consortium associate or regular membership is required.

A List of Zhaga approved test centres can be found [here](#). Only specific test centres can certify for specific books. Test centres can offer advise and direction with product approval, as well as DALI and D4i testing.